

800 F STREET NW

WASHINGTON, DC 20004

Retail Space For Lease

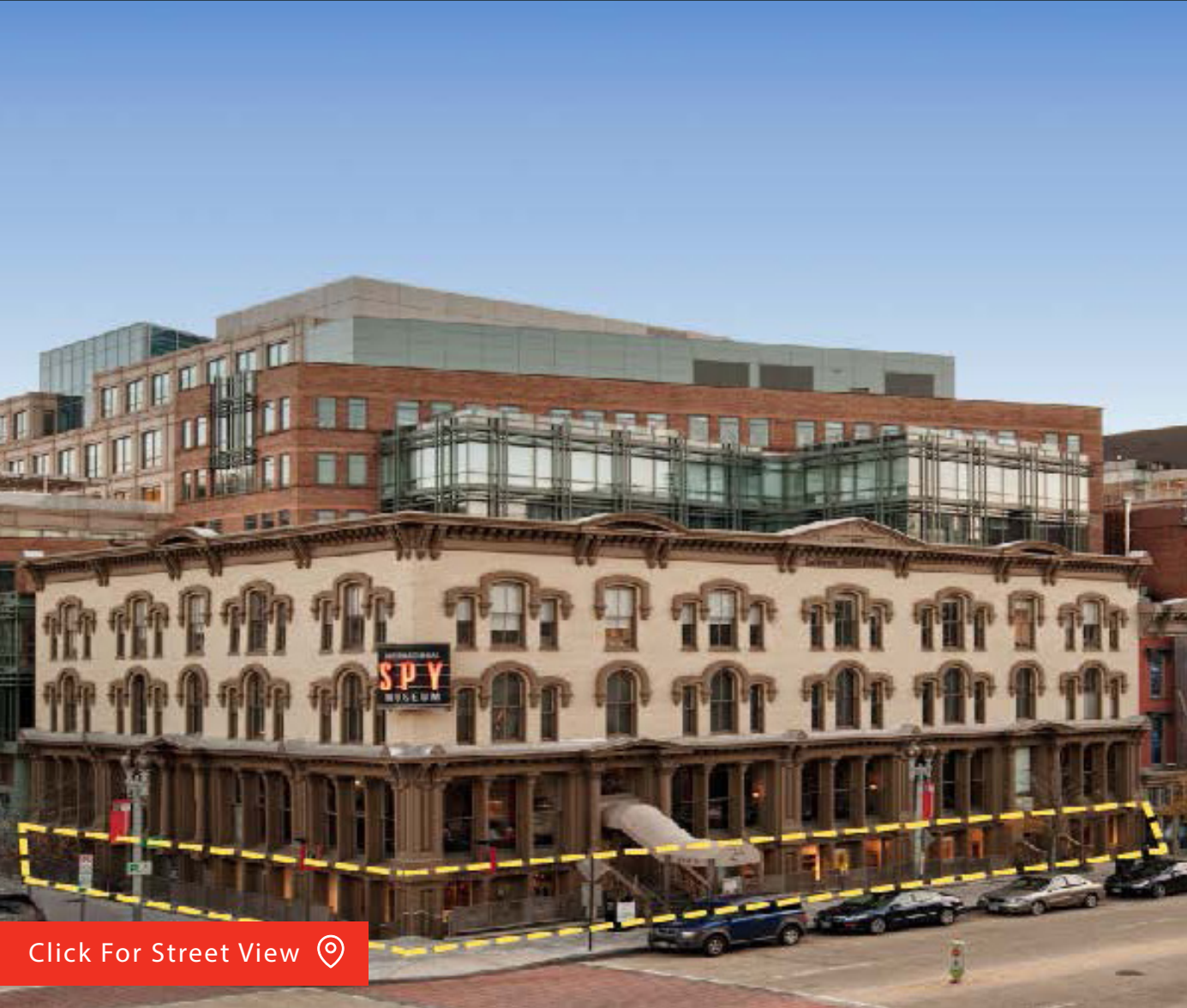

[Click For Street View](#) 

PROPERTY TYPE:

103,593 SF

AVAILABILITY:

13,474 SF

ABOUT THE PROPERTY:

Welcome to Historic Row, a Douglas Development Site. Join Shake Shack and Nando's in our remaining 13,474 SF. Perfect for dining or entertainment across from Capitol One Arena and The Smithsonian Portrait Gallery.

JOIN THESE RETAILERS:



puttery

Nick Alevrogiannis

D | 571.765.4419

C | 443.804.3933

nalevro@renaudconsulting.net

Andrew Poncher

D | 571.765.4430

C | 312.399.5566

aponcher@renaudconsulting.net



Leasing Plan

UNIT	TENANT	SF
1	Available	13,474
2	Nandos	2,700
3	Shake Shack	3,000

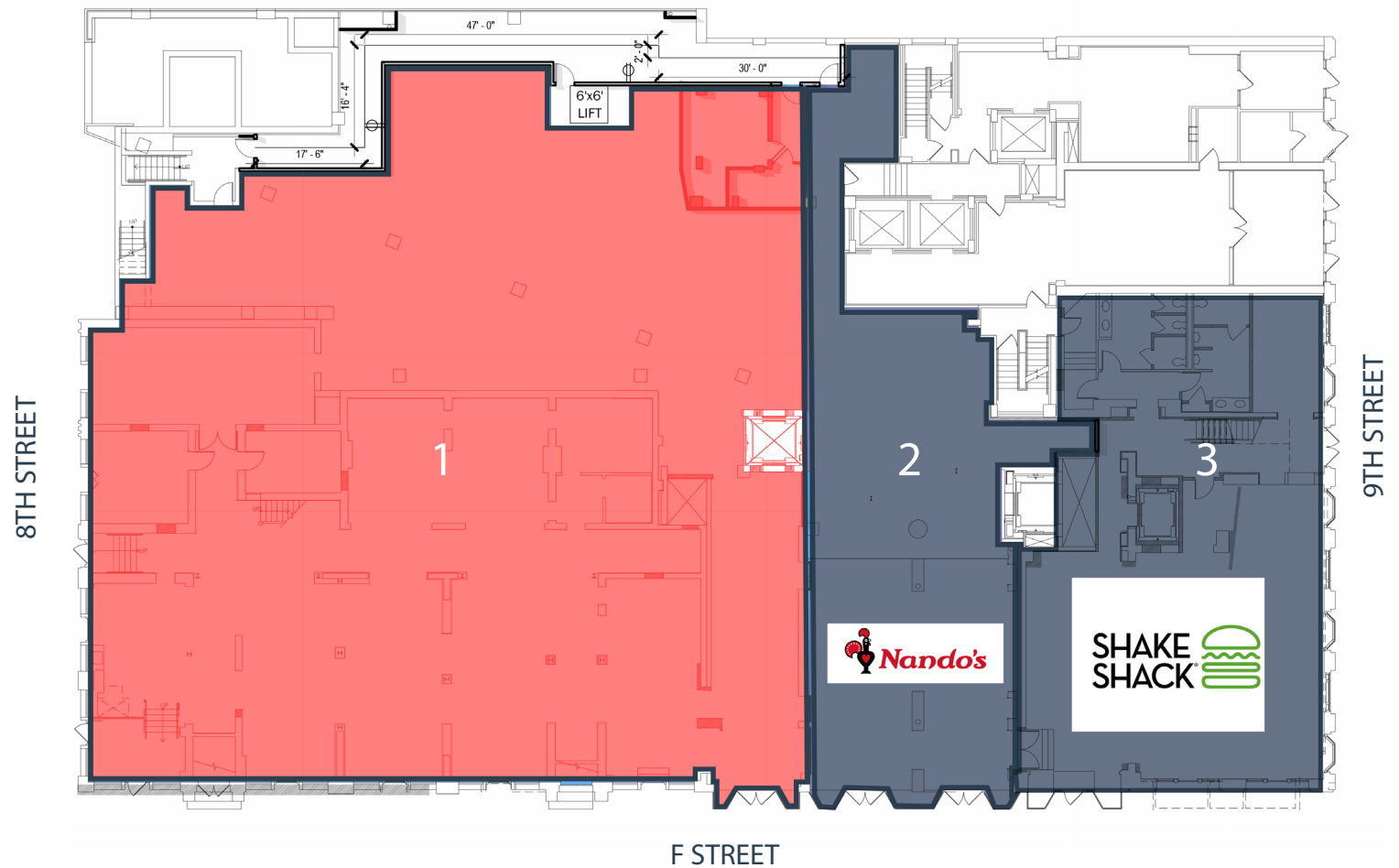

Location Map

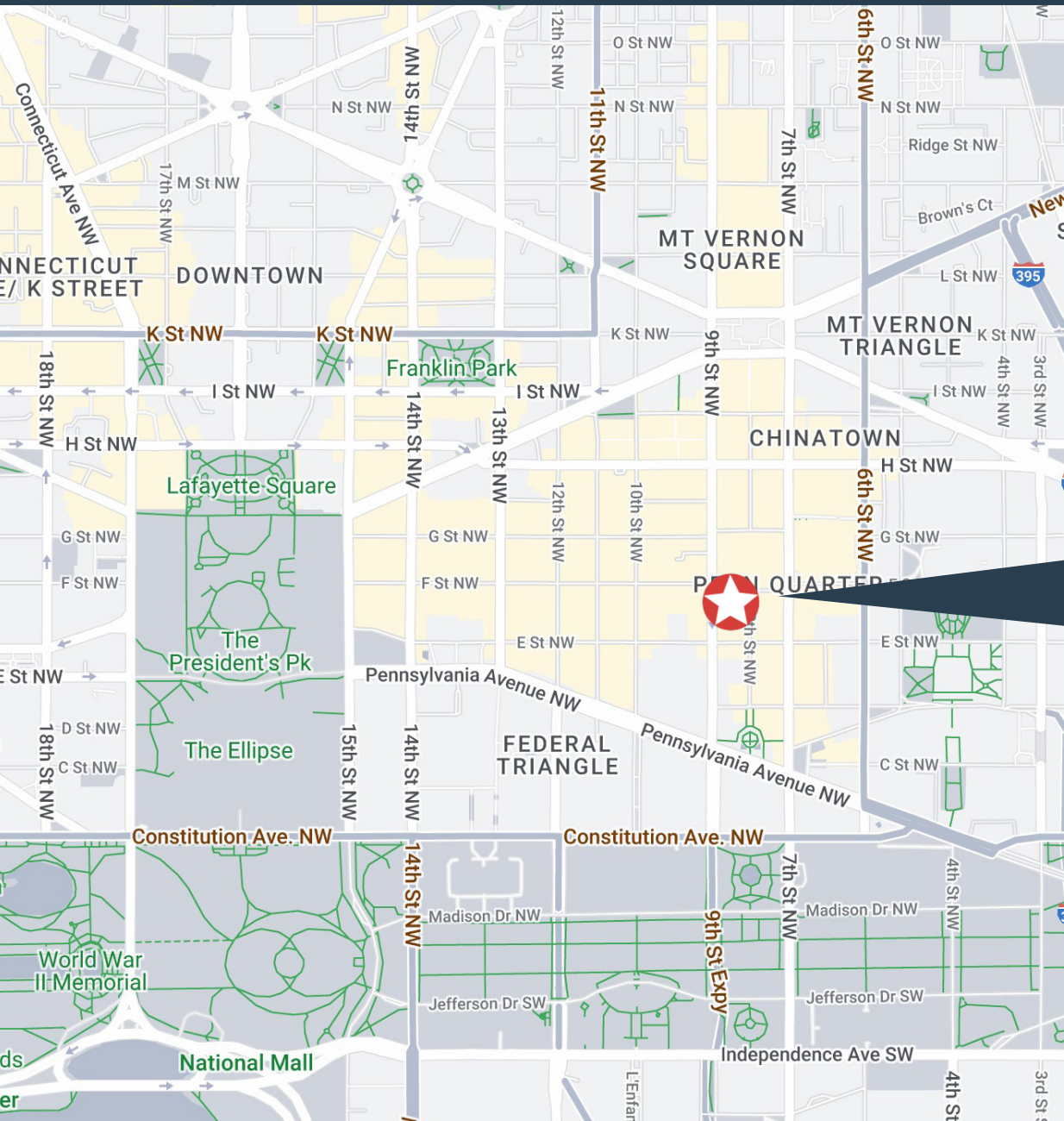

DEMOGRAPHICS

10 MINUTE WALK TIME

DAYTIME POPULATION	AVG. INCOME
90,059	\$176,889
TOTAL HOUSEHOLD	RESIDENTIAL POPULATION
1,410	2,027

TRAFFIC COUNTS

8TH STREET NW	3,995 ADT
9TH STREET NW	20,875 ADT
F STREET	5,453 ADT

[CLICK FOR DEMOGRAPHIC REPORT](#)

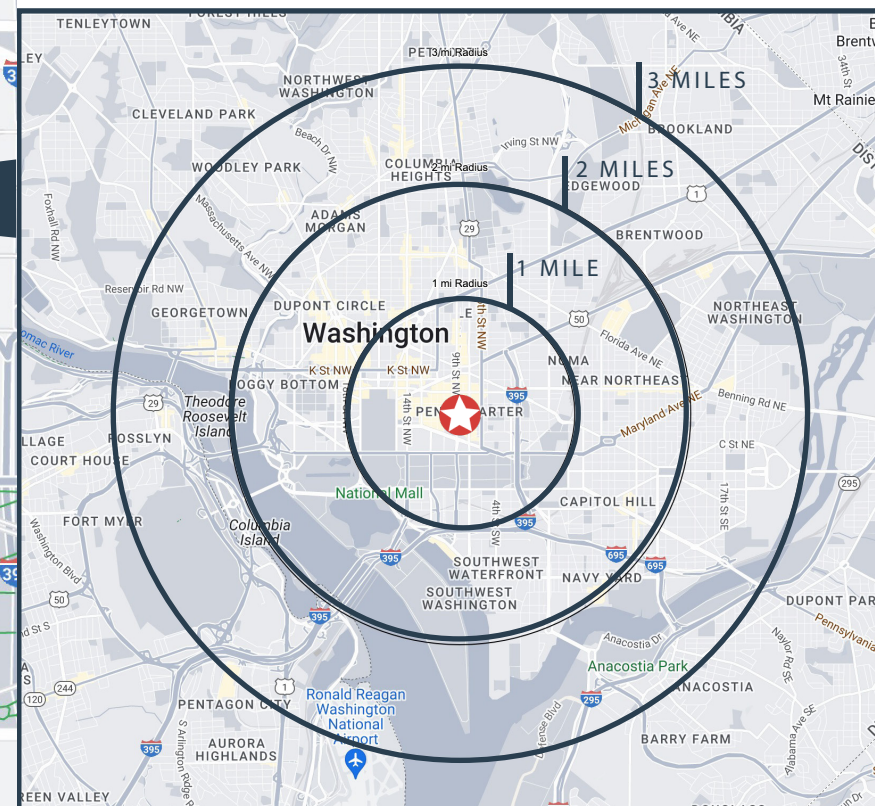

Retail Trade Area Map

CO-TENANCY

800 F Street NW
Washington DC

Demos	1 Mile	2 Mile	3 Mile
Population	41,127	225,613	383,441
Average Household Income	\$171,086	\$177,441	177,467
Bachelors Degree +	72%	79%	73%
Daytime Population	193,800	448,881	648,425

